

Flanged Washers

Steel / Stainless Steel, for Toggle Clamps

SPECIFICATION

- Steel **ST**
Zinc plated, blue passivated
- Stainless steel **AISI 304 NI**

INFORMATION

Flanged washers GN 898 are used to attach and position pressure elements on toggle clamps with open clamping arm. The corresponding toggle clamps are listed in the table.

TECHNICAL INFORMATION

- Stainless Steel Characteristics (see page A26)



Assembly instruction

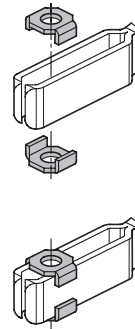
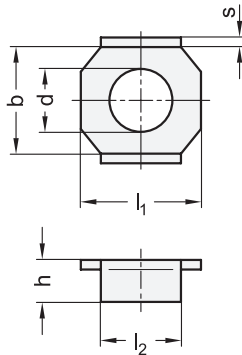

GN 898-ST

Description	d Nominal size	d Actual dimension	b	h	l ₁	l ₂	s	For	For	For	For	
								toggle clamps GN 810 GN 810.1 GN 810.3 GN 810.4 GN 812.1		toggle clamps GN 812		toggle clamps GN 820 GN 820.1 GN 820.3 GN 820.4
GN 898-4-ST	4	4.3	7.2	2.5	9	5	0.8	-	-	25	-	1
GN 898-5-ST	5	5.5	9.8	3.5	12	7.5	1	75	-	75	80	2
GN 898-6-ST	6	6.5	11.8	4.5	15	9	1.2	13	-	130	-	3
GN 898-8-ST	8	8.5	15	5.5	18	12.5	1.5	23	200	230	140	4
GN 898-10-ST	10	10.5	18	6	23	16.5	2	330	300	355	250	7
GN 898-12-ST	12	13	24	7	30	18	2.5	430 530	-	455	-	14

GN 898-NI

STAINLESS STEEL

Description	d Nominal size	d Actual dimension	b	h	l ₁	l ₂	s	For	For	For	For	
								toggle clamps GN 810 GN 810.1 GN 810.3 GN 810.4 GN 812.1		toggle clamps GN 812		toggle clamps GN 820 GN 820.1 GN 820.3 GN 820.4
GN 898-4-NI	4	4.3	7.2	2.5	9	5	0.8	-	-	25	-	1
GN 898-5-NI	5	5.5	9.8	3.5	12	7.5	1	75	-	75	80	2
GN 898-6-NI	6	6.5	11.8	4.5	15	9	1.2	13	-	130	-	3
GN 898-8-NI	8	8.5	15	5.5	18	12.5	1.5	23	200	230	140	4
GN 898-10-NI	10	10.5	18	6	23	16.5	2	330	300	355	250	8